

ASSOCIATED HOBBY MANUFACTURERS, INC.



7201 Locomotive Kit

7201-M Motorizing Kit

MADE IN ITALY BY **Rivarossi**

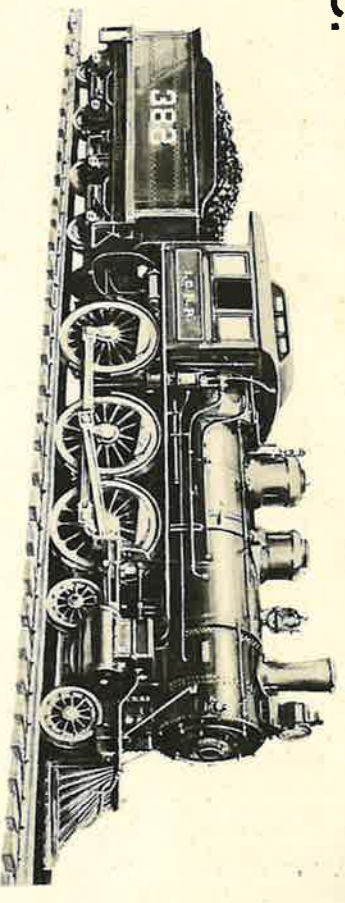

ASSEMBLY INSTRUCTIONS

PROTOTYPE HISTORY AND DATA

Most people familiar with the famous ballad of Casey Jones are probably unaware, that Casey is not exclusively a creation of folklore. Railroad hobbyists realize however, that he was a definite historic figure. On April 30, 1900 the engineer of famous Illinois Central No. 1 was killed. When locomotive No. 1 slammed into the rear of a standing freight train. The engine was rebuilt and remained in passenger service. These engines, when retired in the 30 ths, had 69 inch drivers, 180 pounds of pressure and weighed 185, 300 pounds. More engines of the same class were built during the last years of the 19th century.

BUILDING HINTS

The model supplied in this kit is without motor but can be easily motorized by using the additional kit 7201-M for 2 rail 12 V D.C. operation. **Maximum absorption 0.65 + 0.7 Amp.** The diagrams and the assembly instructions are part in black and part in red. The black part of the instructions

refers to the assembly of the locomotive without motor while the red part is the additional instruction for the motorization. The electric wirings have reference letters and the terminal must be soldered. The assembled dummy locomotive can be later on motorized if you have carefully followed the assembly instructions. To motorize the built up dummy loco disassemble it where required. Replace dummy parts with motorizing kit ones where needed; add new parts as necessary. All required parts are included in 7201-M box.

FOR BEST RESULTS READ THIS FIRST

1) All parts are numbered for easy identification, or the numbers are engraved on the part or on the bar next to the part. Carefully remove each part from its bar **ONLY WHEN THAT PART IS TO BE USED.** As an aid to finding each individual part, the groups of plastic parts are labeled A, B, C, ... as shown. Each part in the instruction is called by its number and by the group letter. For instance: 13D means part 13

which can be found in group D.
2) Since this kit is moulded of Styrene Plastic of suitable cement. **Do not let cement touch furniture.**
3) Apply cement sparingly. Excess cement details on your model. Also be careful when moving parts are involved.
4) Carefully trim any excess plastic from parts small file or model builder's knife and blade fitting together perfectly, and enable moving parts.
5) Start with Part No. 1A and cement it to follow these numbered steps for ease in **DO NOT RUSH.**
6) All plastic parts are moulded in the actual only need to line or paint in different colours

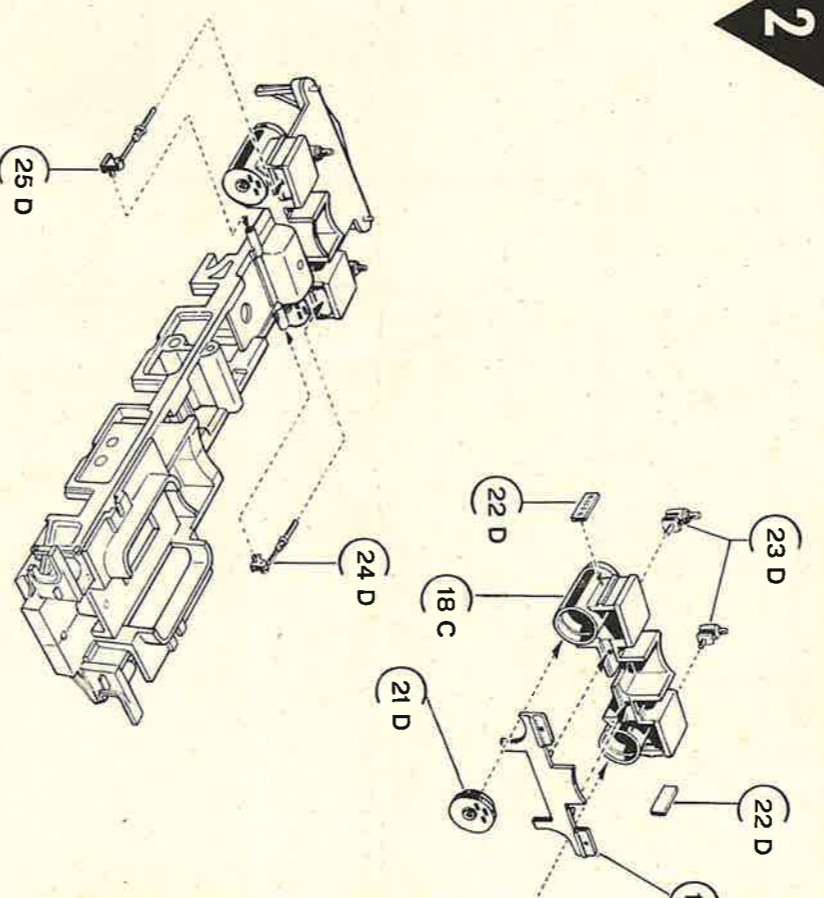
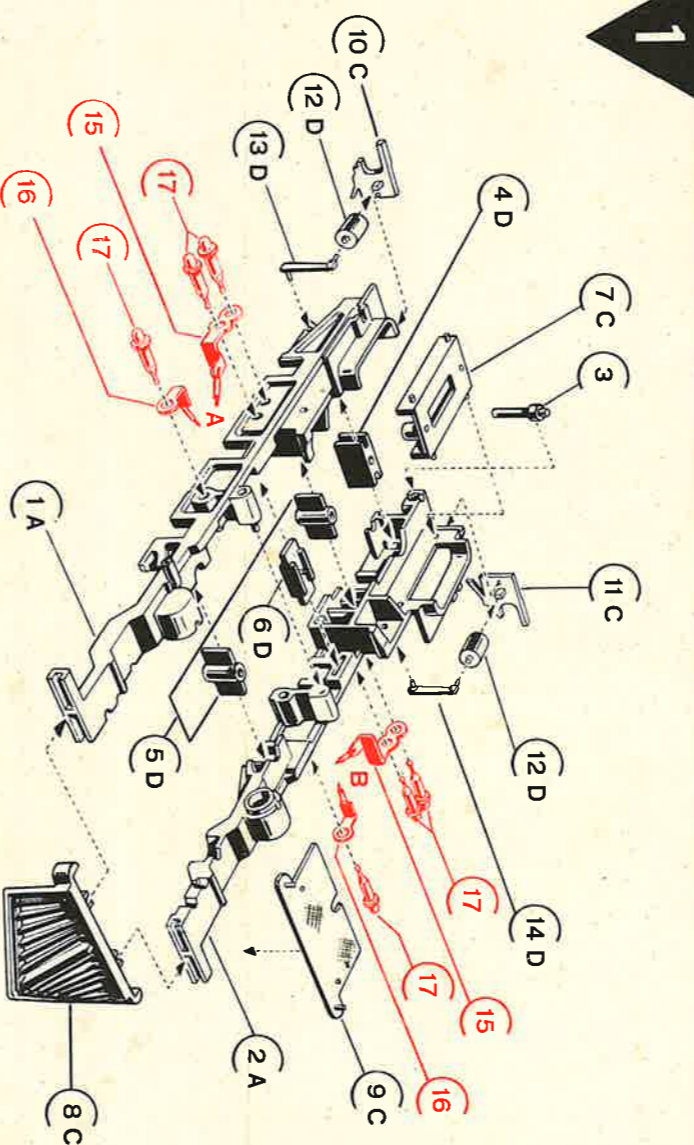

FRAME ASSEMBLY

Cement together frame right-hand side (1A) and left-hand side (2A) locating in between tender draw-bar metal pin (3), spacers (4D) (5D), part (6D) and motor bracket (7C), Cement pilot (8C) and front footplate floor (9C) to front frame end. Cement to the rear frame end right (10C) and left (11C) cab support-plates. To (10C) and (11C) cement respectively brake cylinders (12D), Cement then one end of parts (13D) (14D) to cylinders (12D) and the other one to foreseen holes on frame. Now you can spray paint in black this subassembly **CURRENT PICKUP ASSEMBLY** Solder 5" long cable pieces to terminal plates (15) and (16). Parts (15) will be pressure fixed into frame sides by two plungers (17), parts (16) with only one plunger (17).

CYLINDERS ASSEMBLY AND ASSEMBLY OF SAME TO FRAME
To main cylinders body (18C) cement rear part (19C), right hand cover (20D) and (21D). On cylinders sides cement plates (22D) and in front of each cylinder a drain. Now you can spray paint in black this subassembly Plates (22D) must be painted in black. Cement now the assembled cylinders to frame assembly. Between cylinders and frame cement parts (24D) and (25D) and paint them in silver.

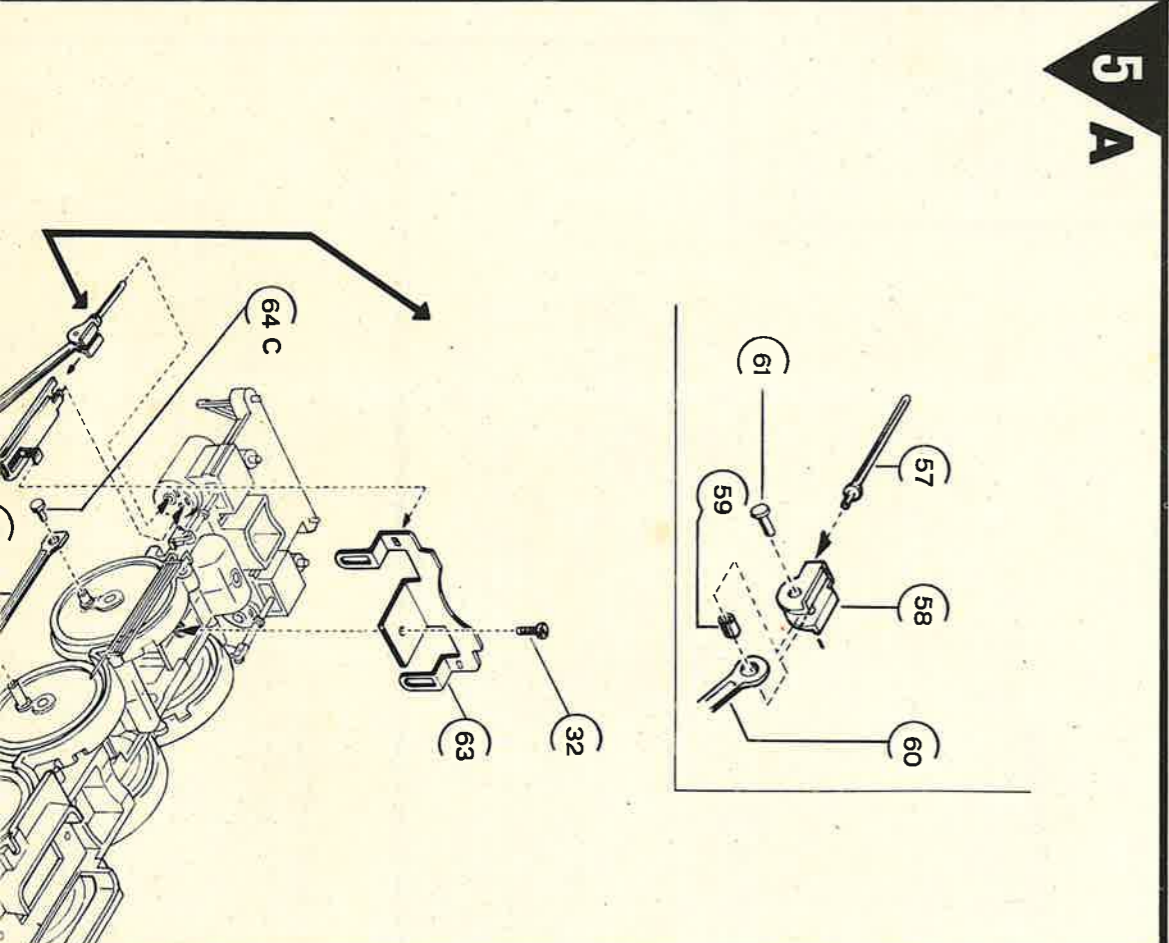
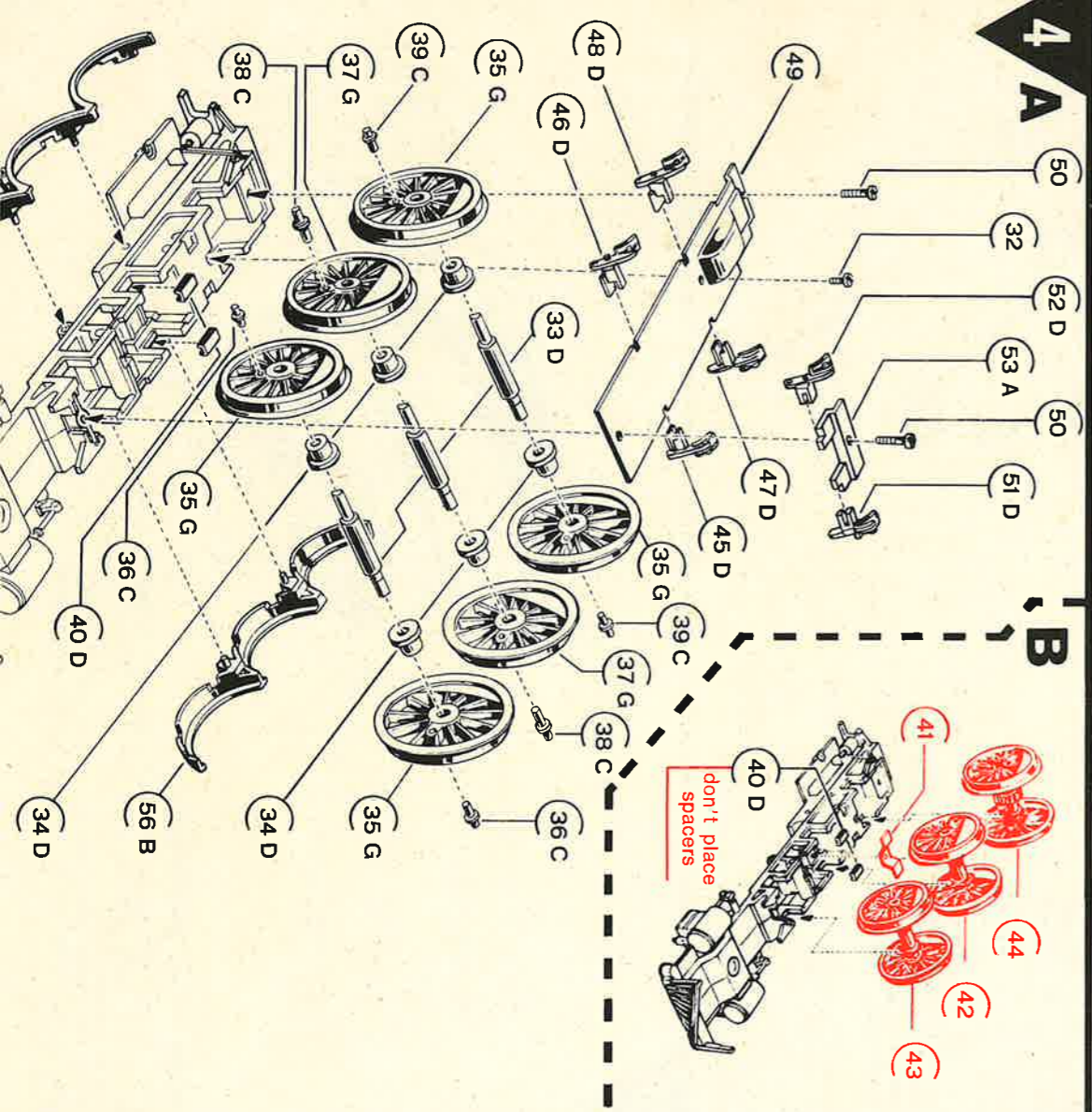

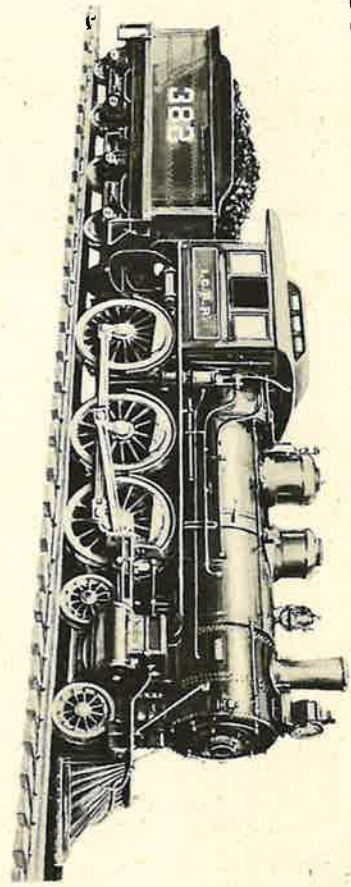

CASEY JONES

Cannon Ball Express

Kit Kit

1" GAUGE

1 1/4 INCH SCALE MODEL

the assembly of the locomotive without motor while the red part additional instruction for the motorization. The electric wirings reference letters and the terminal must be soldered. assembled dummy locomotive can be later on motorized if you have followed the assembly instructions. To motorize the built up loco disassemble-it where required. Replace dummy parts with kit ones where needed; add new parts as necessary. All parts are included in 7201-M box.

BEST RESULTS READ THIS FIRST

parts are numbered for easy identification, or the numbers are on the part or on the bar next to the part. Carefully remove part from its bar **ONLY WHEN THAT PART IS TO BE USED.** Aid to finding each individual part, the groups of plastic parts called A, B, C, etc., as shown. Each part in the instruction is called number and by the group letter. For instance: 13D means part 13

which can be found in group D.
2) Since this kit is moulded of Styrene Plastic, use only a good brand of suitable cement. Do not let cement touch your eyes, clothing or furniture.
3) Apply cement sparingly. Excess cement may run and damage the details on your model. Also be careful when applying cement where moving parts are involved.
4) Carefully trim any excess plastic from parts before assembling, using small file or model builder's knife and blades. This will result in parts fitting together perfectly, and enable moving parts to move freely.
5) Start with Part No. 1A and cement it to part No. 2A etc... Carefully follow these numbered steps for ease in building your locomotive. **DO NOT RUSH.**
6) All plastic parts are moulded in the actual colour of the loco. You only need to line or paint in different colours some parts as suggested

In the assembly instructions. Who wants to spray paint the wheels must carefully follow the instructions while assembling the model styrene plastic parts only.
7) Directions for applying decals:
a) Cut each design from decal sheet as needed.
b) Dip in water for few seconds.
c) After a minute slide decal from paper face up.
d) Use a small brush to wet your model and slide decal into place.
e) Do not touch decal with fingers.
f) Press down with blotter.
8) There are certain areas on your locomotive that should be painted to help parts run smoothly. For instance: axle bearings, rod-bearings, transmission gear of the motorized loco use fine grease.

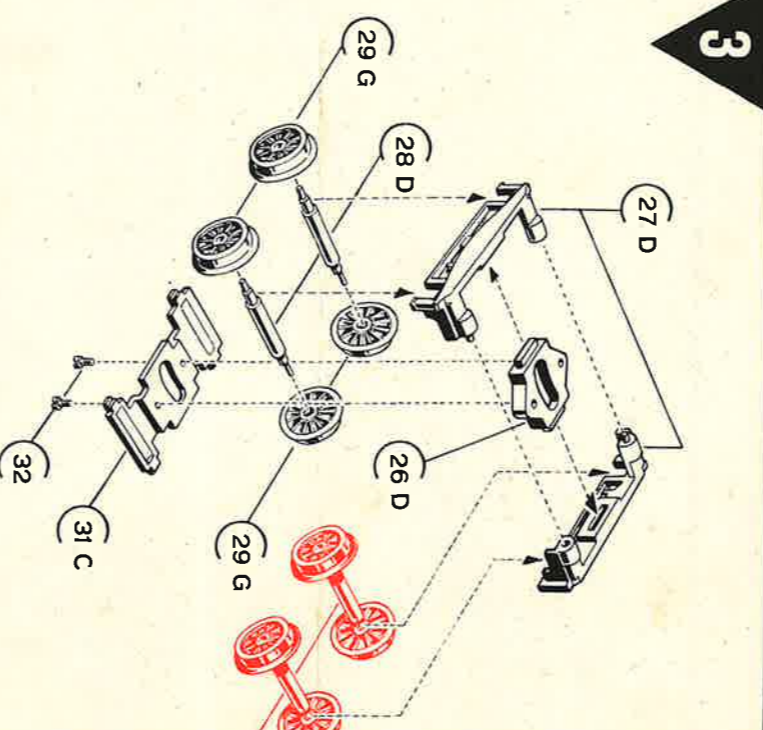
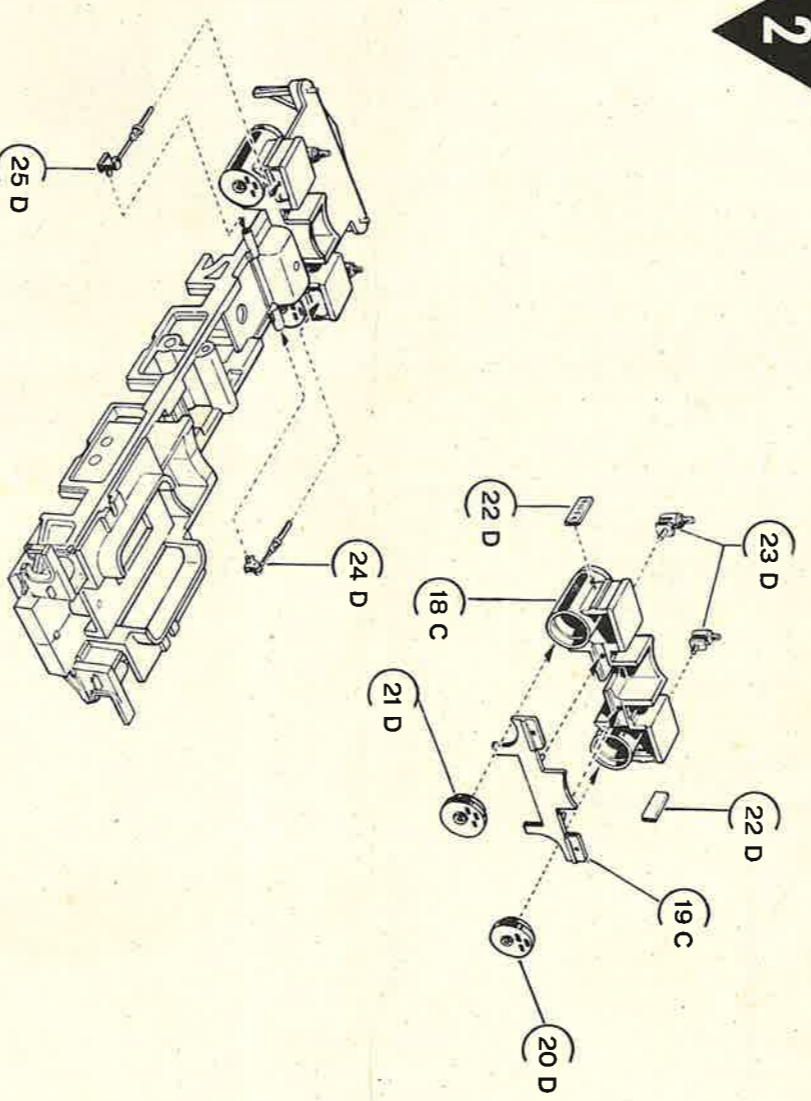
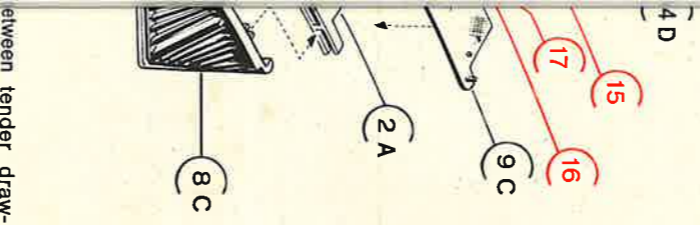

between tender draw-

c) and (11c) cement
o foreseen holes on
sure fixed into frame

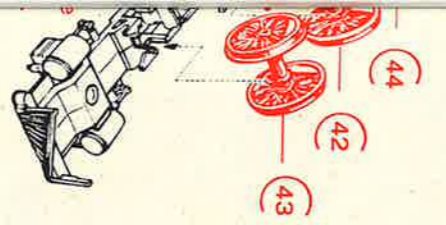

CYLINDERS ASSEMBLY AND ASSEMBLY OF SAME TO FRAME

To main cylinders body (18c) cement rear part (19c), right hand cover (20d) and the left hand one (21d). On cylinders sides cement plates (22d) and in front of each cylinder a drain cock (23d). Now you can spray paint in black this subassembly plates (22d) must be painted in gold. Cement now the assembled cylinders to frame assembly. Between cylinders and frame cement parts (24d) and (25d) and paint them in silver

5 A

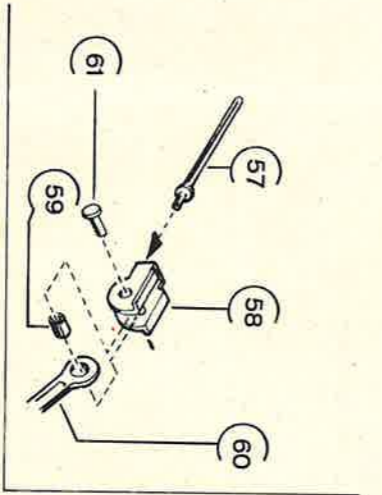

B

FRONT TRUCK ASSEMBLY

Cement to bolster (26d) the two side frames (27d). Now you can spray paint in black this subassembly Force axles (28d) into spoked wheels (29g) then cement point of wheels center from outside. Drop assembly into truck body. Instead of said axles with wheels drop assembled axles with wheels underplate (31c) with two self tapping screws (32) to tru to keep axles with wheels in place.

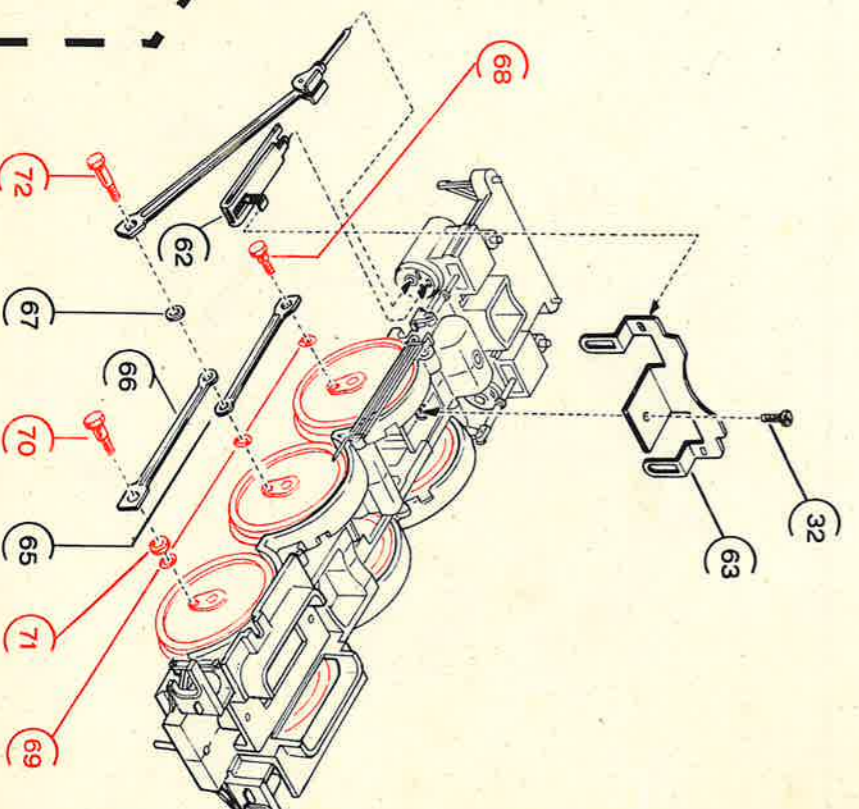
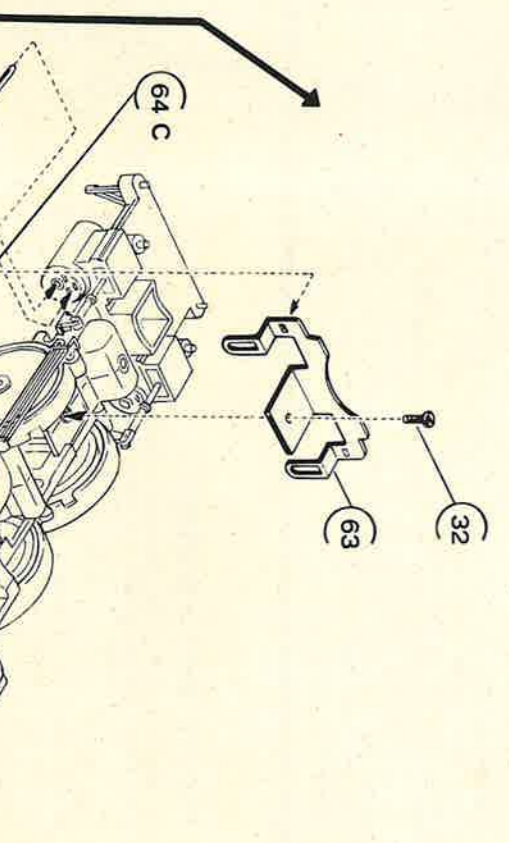

...the letters and the terminal number soldered.
 allowed dummy locomotive can be later on motorized if you have
 disassembled the assembly instructions. To motorize the built up
 kit ones where needed; add new parts as necessary. All
 parts are included in 7201-M box.

TEST RESULTS READ THIS FIRST

Parts are numbered for easy identification, or the numbers are
 on the part or on the bar next to the part. Carefully remove
 from its bar **ONLY WHEN THAT PART IS TO BE USED.**
 to finding each individual part, the groups of plastic parts
 d A, B, C, ... as shown. Each part in the instruction is called
 by A, B, C, ... and by the group letter. For instance: 13D means part 13

of suitable cement. Do not let cement touch your eyes, clothing or
 furniture.
 3) Apply cement sparingly. Excess cement may run and damage the
 details on your model. Also be careful when applying cement where
 moving parts are involved.
 4) Carefully trim any excess plastic from parts before assembling, using
 small file or model builder's knife and blades. This will result in parts
 fitting together perfectly, and enable moving parts to move freely.
 5) Start with Part No. 1A and cement it to part No. 2A etc... Carefully
 follow these numbered steps for ease in building your locomotive.
DO NOT RUSH.
 6) All plastic parts are moulded in the actual colour of the loco. You
 only need to line or paint in different colours some parts as suggested

styrene plastic paints only.
 7) Directions for applying decals:
 a) Cut each design from decal sheet as needed.
 b) Dip in water for few seconds.
 c) After a minute slide decal from paper face up.
 d) Use a small brush to wet your model and slide decal into place.
 e) Do not touch decal with fingers.
 f) Press down with blotter.
 8) There are certain areas on your locomotive that should be lubricated
 to help parts run smoothly; for instance: axle bearings, rod-bearing
 To lubricate use small amounts of "Vaseline oil". To lubricate
 transmission gear of the motorized loco use fine grease.

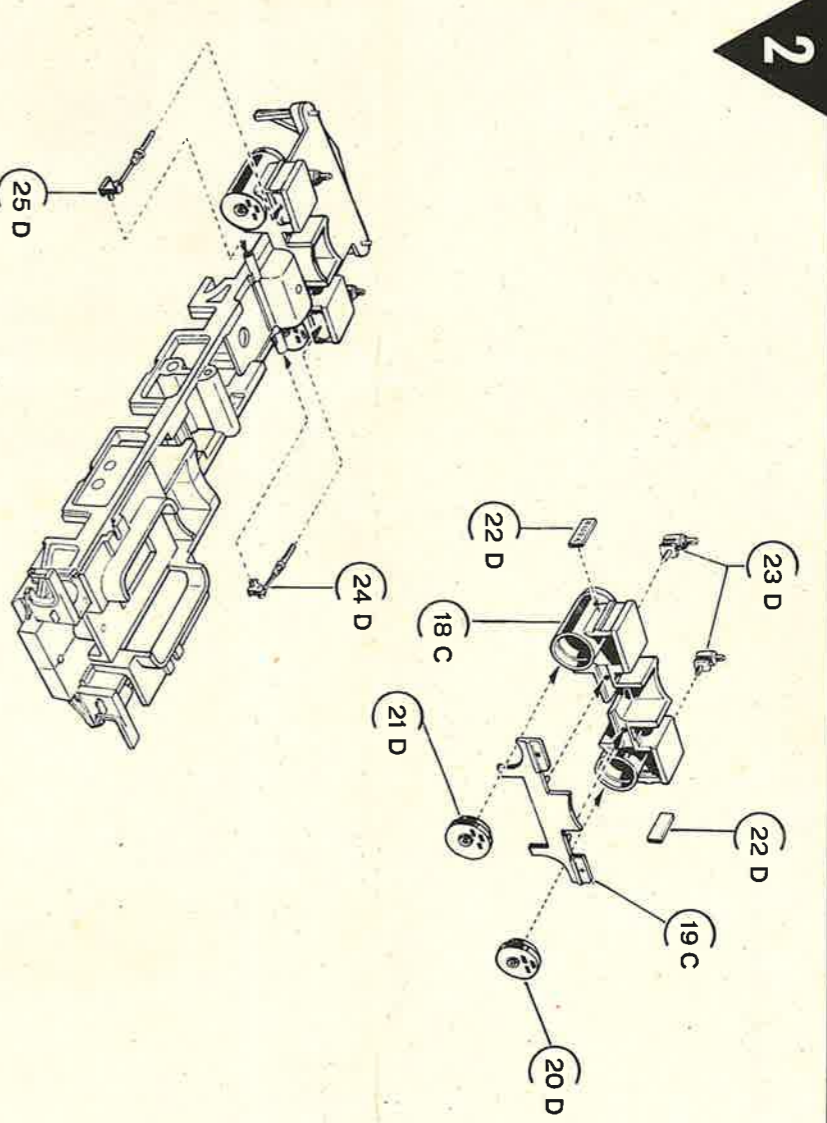
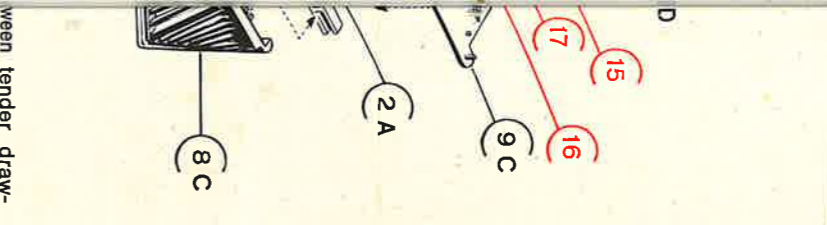

and (11C) cement
 foreseen holes on
 re fixed into frame

CYLINDERS ASSEMBLY AND ASSEMBLY OF SAME TO FRAME
 To main cylinders body (18C) cement rear part (19C), right hand cover (20D) and the left hand one
 (21D). On cylinders sides cement plates (22D) and in front of each cylinder a drain cock (23D).
 Now you can spray paint in black this subassembly. Plates (22D) must be painted in gold.
 Cement now the assembled cylinders to frame assembly.
 Between cylinders and frame cement parts (24D) and (25D) and paint them in silver

FRONT TRUCK ASSEMBLY
 Cement to bolster (26D) the two side frames (27D).
 Now you can spray paint in black this subassembly.
 Force axles (28D) into spoked wheels (29G) then cement point of axle
 wheels center from outside. Drop assembly into truck body.
 Instead of said axles with wheels drop assembled axles with wheel
 Fasten underplate (31C) with two self tapping screws (32) to truck
 to keep axles with wheels in place.

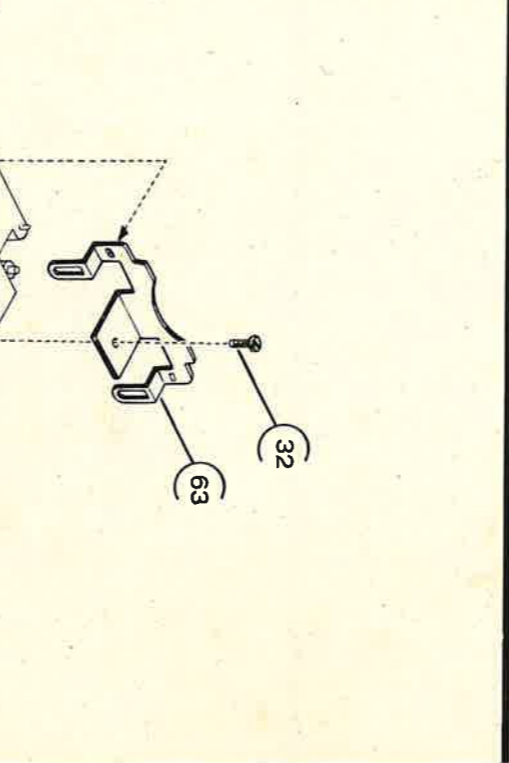
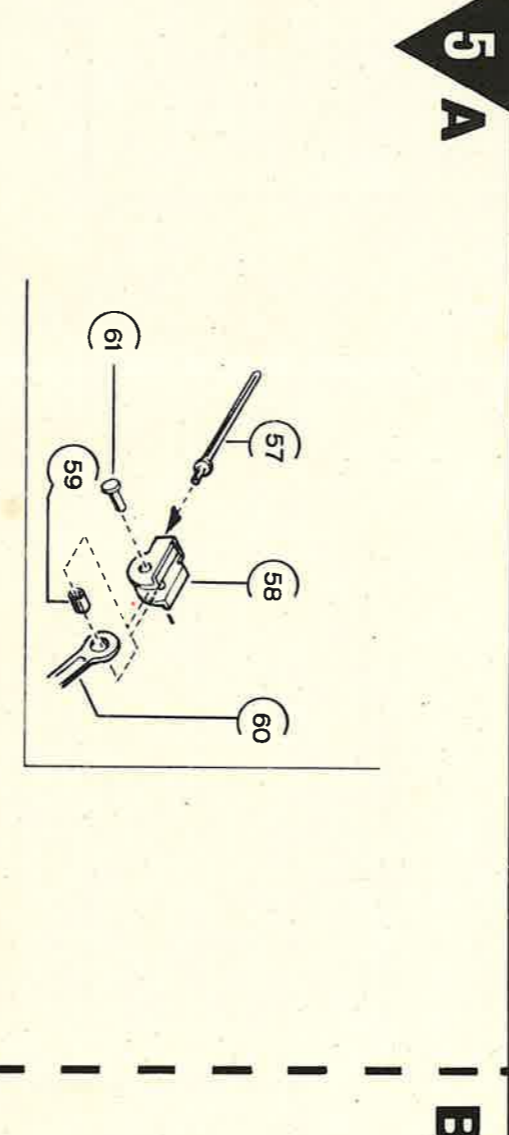
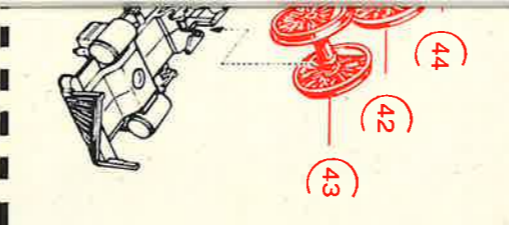

small counterbalance (35G). On wheels
 large counterbalance (37G).
 small counterbalance (35G). On wheels
 their respective places on frame. Before
 shown in correspondence of main driving
 properly housed. Place bushes of front
 bar part.
 on metal underplate (49) that is
 curves brake-shoes of front axles with

SIDE ROD ASSEMBLY
 Left cross-head assembly.
 Drive and rivet piston rod (57) into cross-head (58).
 Insert spacer (59) into main rod (60) hole, place these into cross-head and drive through
 pin (61) that has to be riveted. Repeat same operations for right cross-head, but symme-
 trically. Take left cross-head subassembly and slide cross-head on cross-head guide (62).
 Fit free ends of cross-head guide in housing on cylinder rear cover inserting at same time
 piston rod in hole. At this point do the same on right hand side of loco. Drive main rods
 through big holes of yoke (63). Then insert small holes of same into cross-head guide
 hooks, then fasten to frame with self tapping screw (32). Assemble now with pressure plugs
 (64C) on wheel pins the front (65) and rear (66) side rods.

SEE DRAWING 5 B - Main rod and yoke assembly as for static model.
 assemble the motorized version, side rods must be assembled to wheel
 follows. Assemble with screw (68) the side rod (65) to the wheel
 between a washer (69); assemble rear left side rod (66) to wheel with
 (70). Put washer (69) and spacer (71) in between wheel and rod.
 Drive screw (72) through main rod spacer (67) side rod (66) front

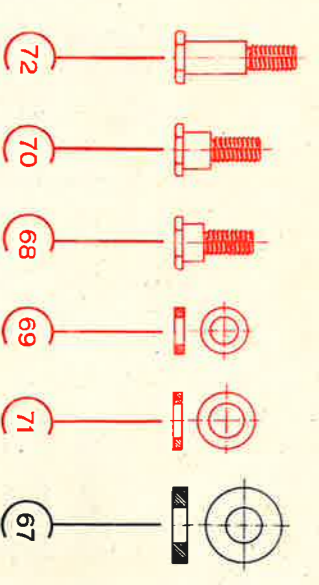

BOILER AND CAB ASSEMBLY

Cement parts (73B) and (74B) together housing in right place plate (75). Cement to boiler body, cab front wall (76A). Cement this assembly on lower boiler part (77A). Assemble cab cementing cab walls (78A) and rear wall (79A). Cement then fire box (80C) inside cab, roof (81C) on top and roof cover (82C) to which windows (83D) will have to be glued before.

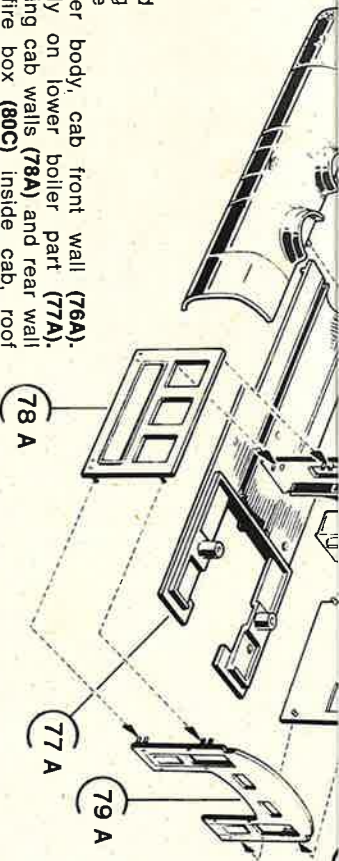

8

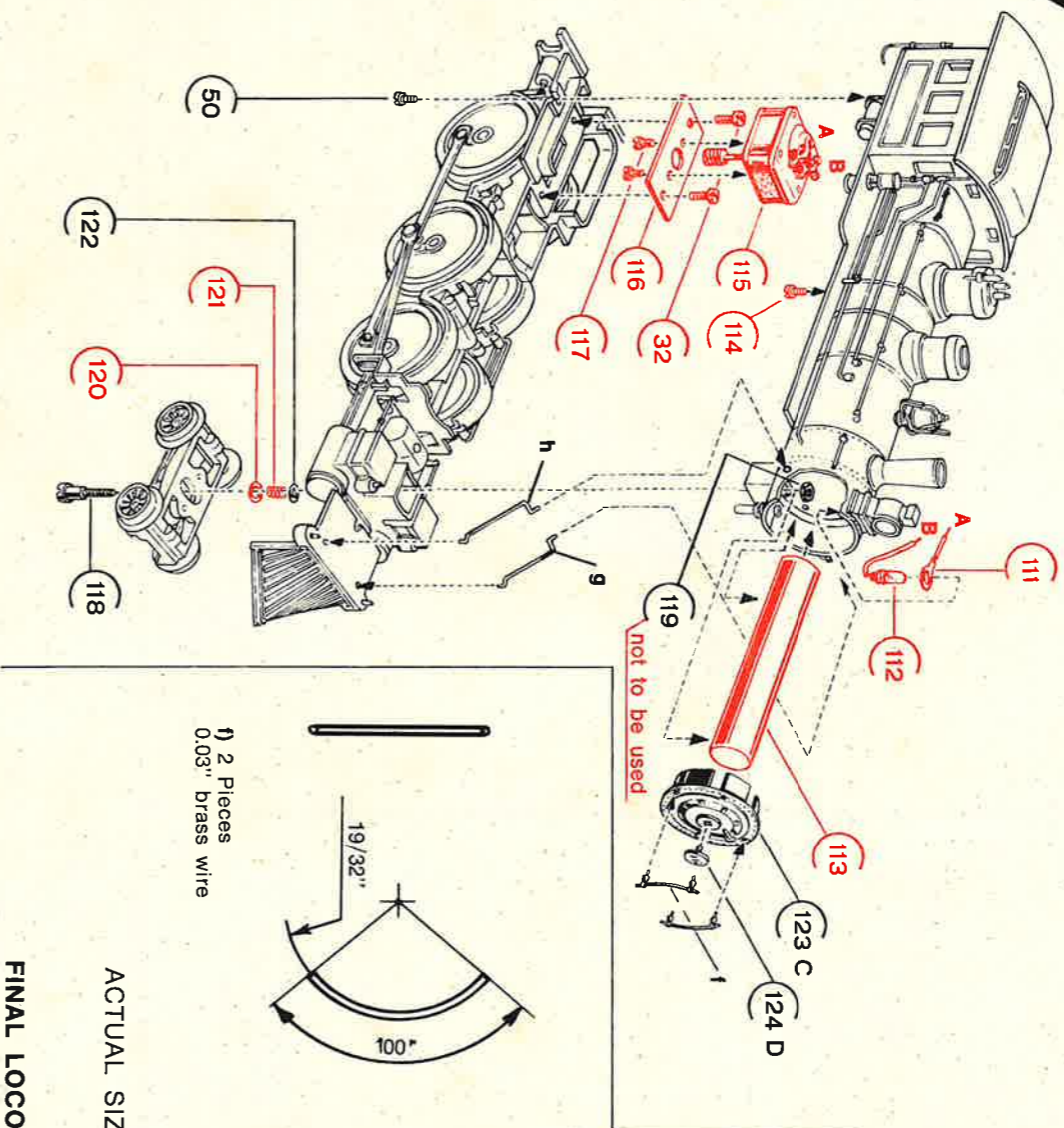

f) 2 Pieces
0.03" brass wire

ACTUAL SIZES

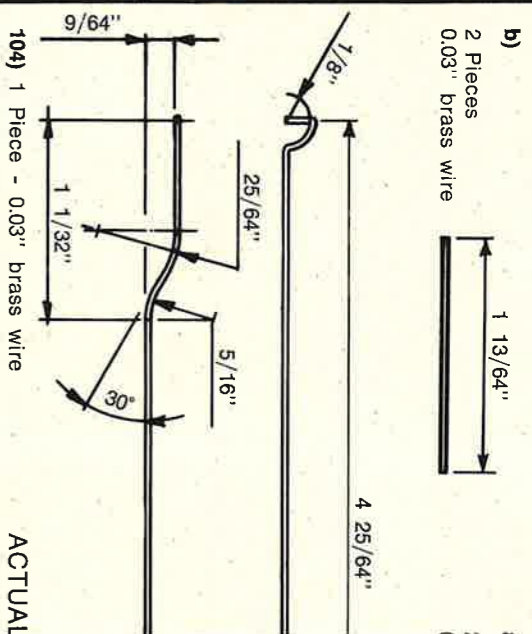
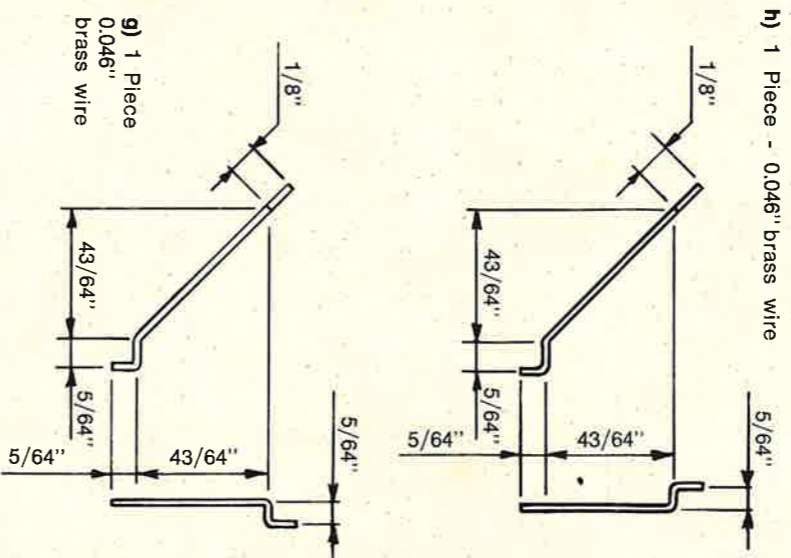

ACTUAL

10

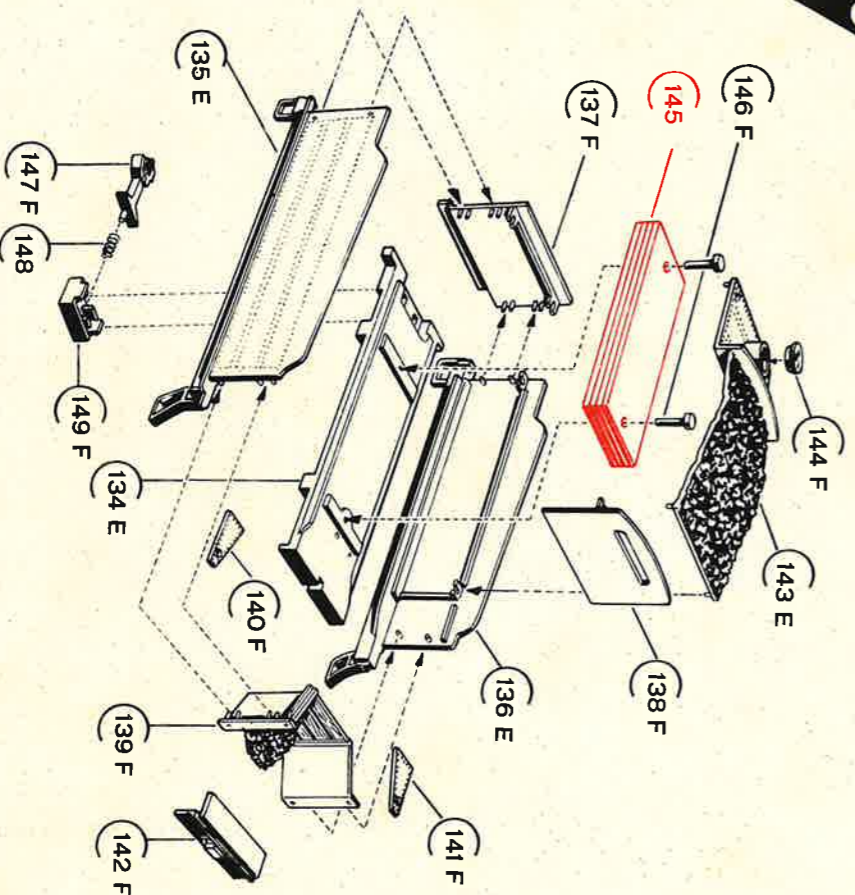

12

FINAL LOCO ASSEMBLY

(Jump the red text for assembled static loco)
Solder to the terminal plate (111) wire 12" long. Solder to bulb end (112) wire 12" long. Insert bulb in terminal plate hole and force it in head-light having driven the wires through boiler. Insert ballast (113) in boiler and fasten it with screw (114). Fasten motor (115) on bracket (116) with two screws (117). Carefully screw assembly on frame with two self tapping screws (32) and leave some play between gear and worm gear. Solder now wires A and B coming from central and rear terminal plates (see figure N. 1) and wires (leave them as long as they are) coming from bulb to motor brush holders. Take care that while soldering you don't overheat motor housing and that wires don't interfere with moving parts. Assemble now boiler and cab to frame with two self tapping screws (50) in the rear part of the loco and with a special screw (118) in front of the loco and nut (119) inside the boiler. This screw will fasten also front part of ballast, nut (119) will not be used. Let screws (50) and (118) loose. The screw (118) will keep in place also front truck preassembled; drive screw through truck then through washer (120) coil spring (121) and washer (122). Shape with supplied brass wire deck-brace left g) right h). Insert them in provided holes and fasten then screws (50) and (118). On smoke box front (123C) cement number plate (124D).
Now you can spray paint in black this subassembly.
The engravings on number plate can be painted in gold.
Shape as shown, with supplied brass wire, handrails (f). Drive them through their brackets (108) that will be fixed in their housing on smoke box front.

TENDER BODY ASSEMBLY

To tender frame (134E) assemble, and check good mash of parts, side wall right (135E) and left (136E), the rear one (137F), the front one (138F), now cement part (139F) in place. On upper front part of tender body cement cover right (140F) and left (141F). Cement cross beam (142F) in front of the tender body cover (143F) and its little cover (144F) cemented must be the housed on tender walls, do not cement, as you need to remove it if you have to fix the tender ballast pieces (145) on tender frame with a couple pressure plugs (146F).
Now you can spray paint in black this subassembly.
Fix, on tender frame coupler, (147F) and its coil spring (148) with small couple box (149F), do not cement.

Y
and
using
plate
boiler body, cab front wall (76A).
assembly on lower boiler part (77A).
cementing cab walls (78A) and rear wall
on fire box (80C) inside cab, roof
roof cover (82C) to which windows
be glued before.

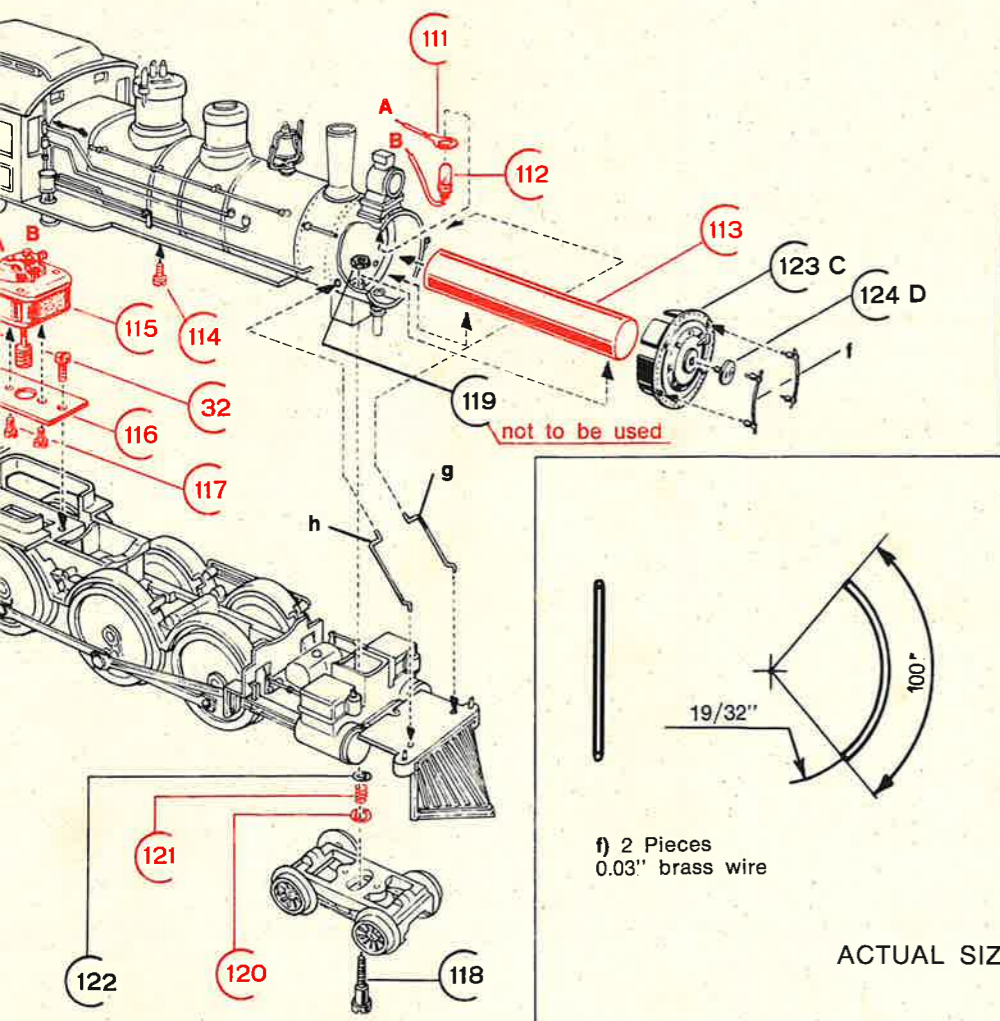
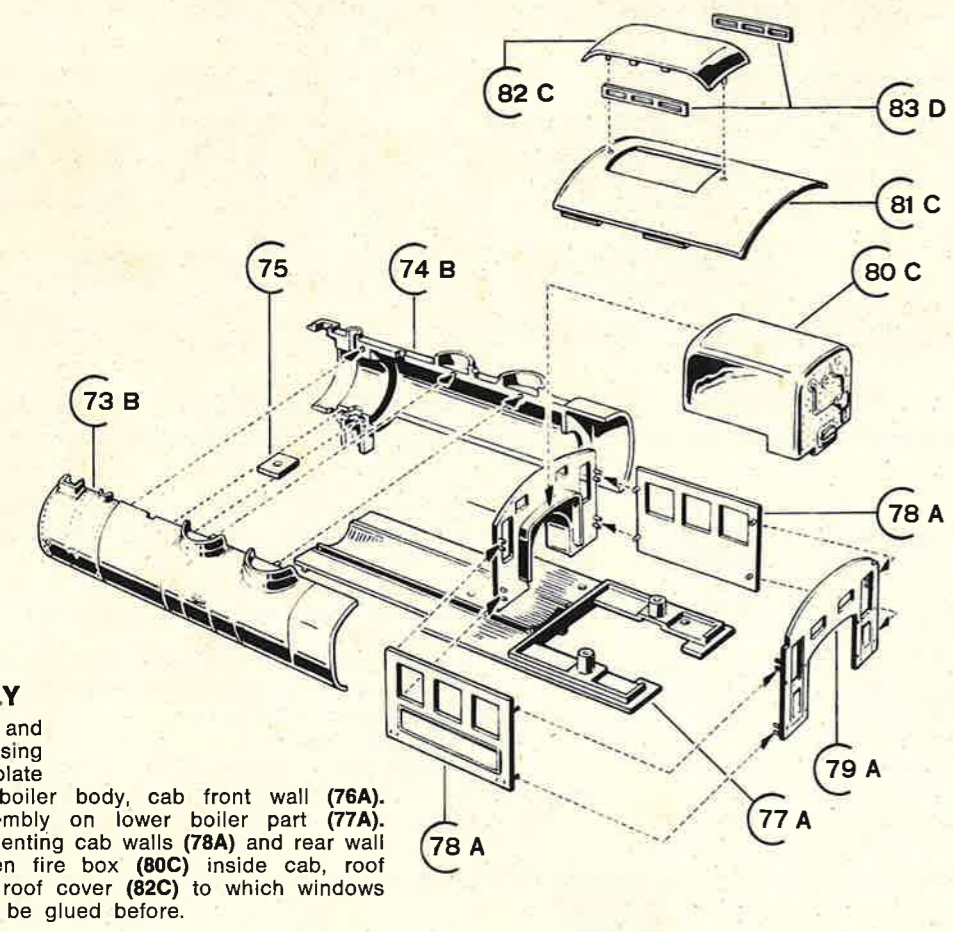

FINAL LOCO ASSEMBLY
(Jump the red text for assembled static loco)
Solder to the terminal plate (111) wire 12" long. Solder to bulb end (112) wire 12" long, insert bulb in terminal plate hole and force it in head-light having driven the wires through boiler. Insert ballast (113) in boiler and fasten it with screw (114). Fasten motor (115) on bracket

7

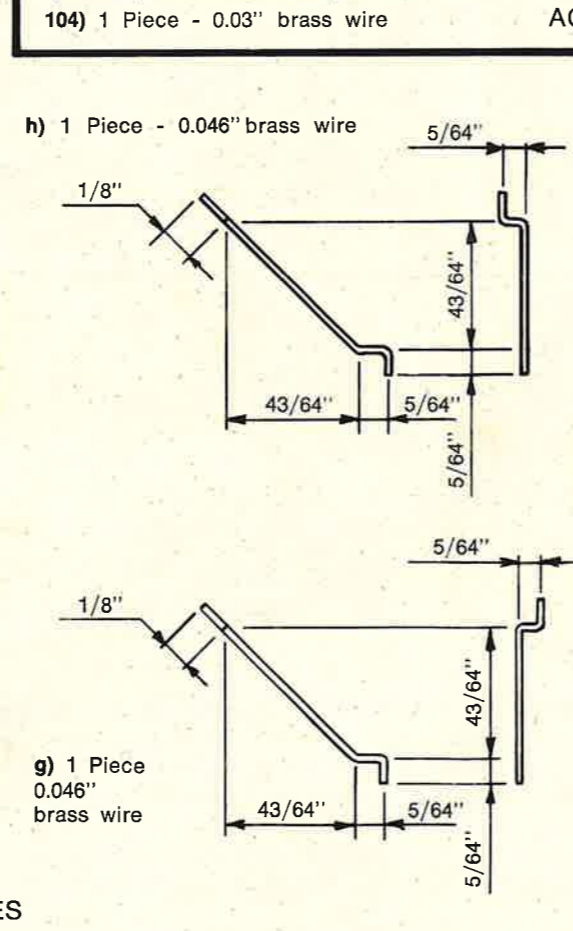
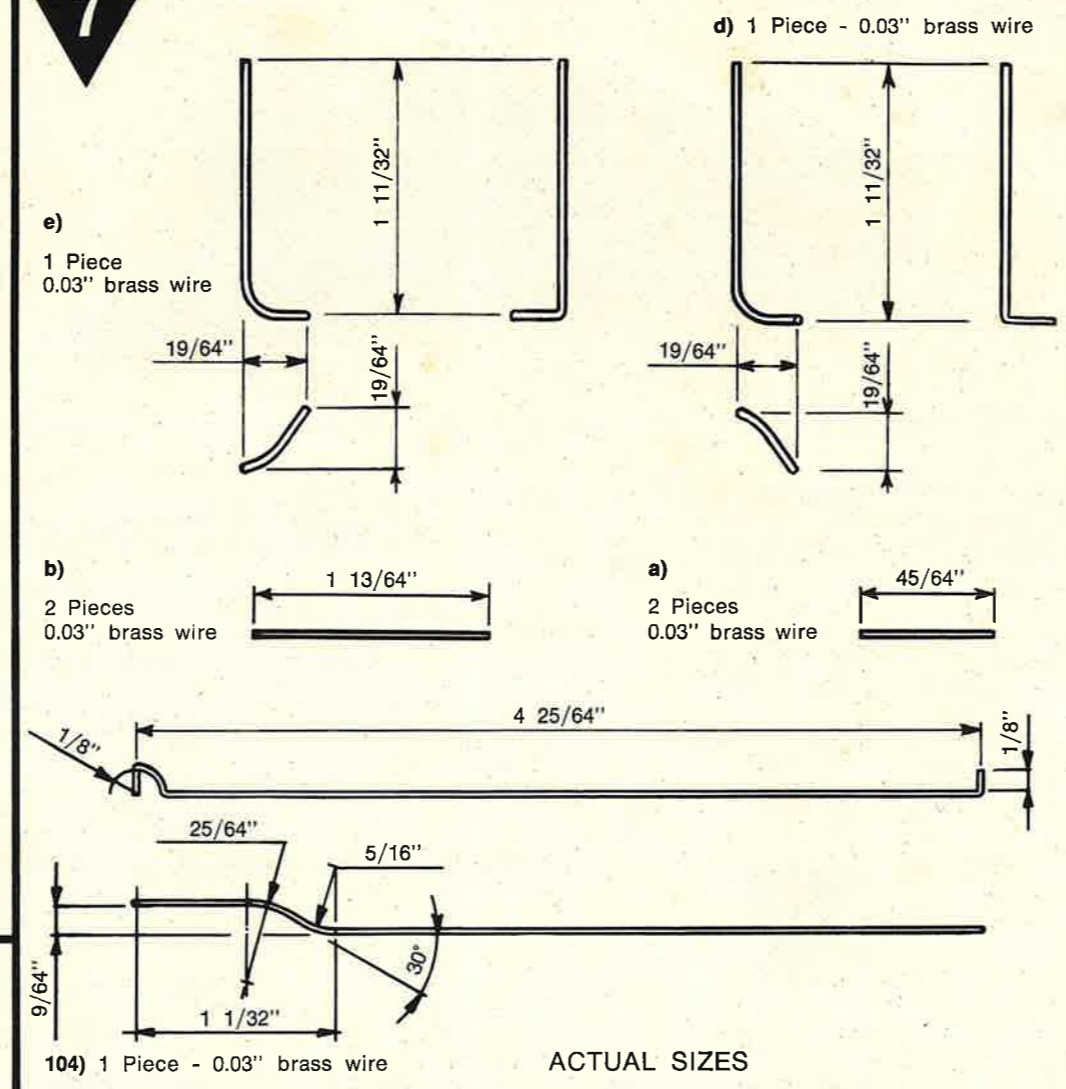

ACTUAL SIZES

d) 1 Piece - 0.03" brass wire

e) 1 Piece 0.03" brass wire

b) 2 Pieces 0.03" brass wire

a) 2 Pieces 0.03" brass wire

104) 1 Piece - 0.03" brass wire

ACTUAL SIZES

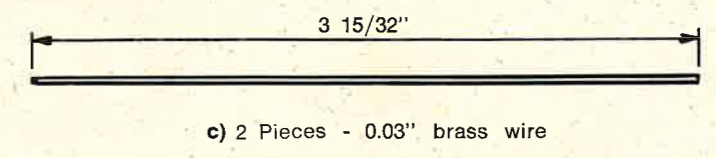

c) 2 Pieces - 0.03" brass wire

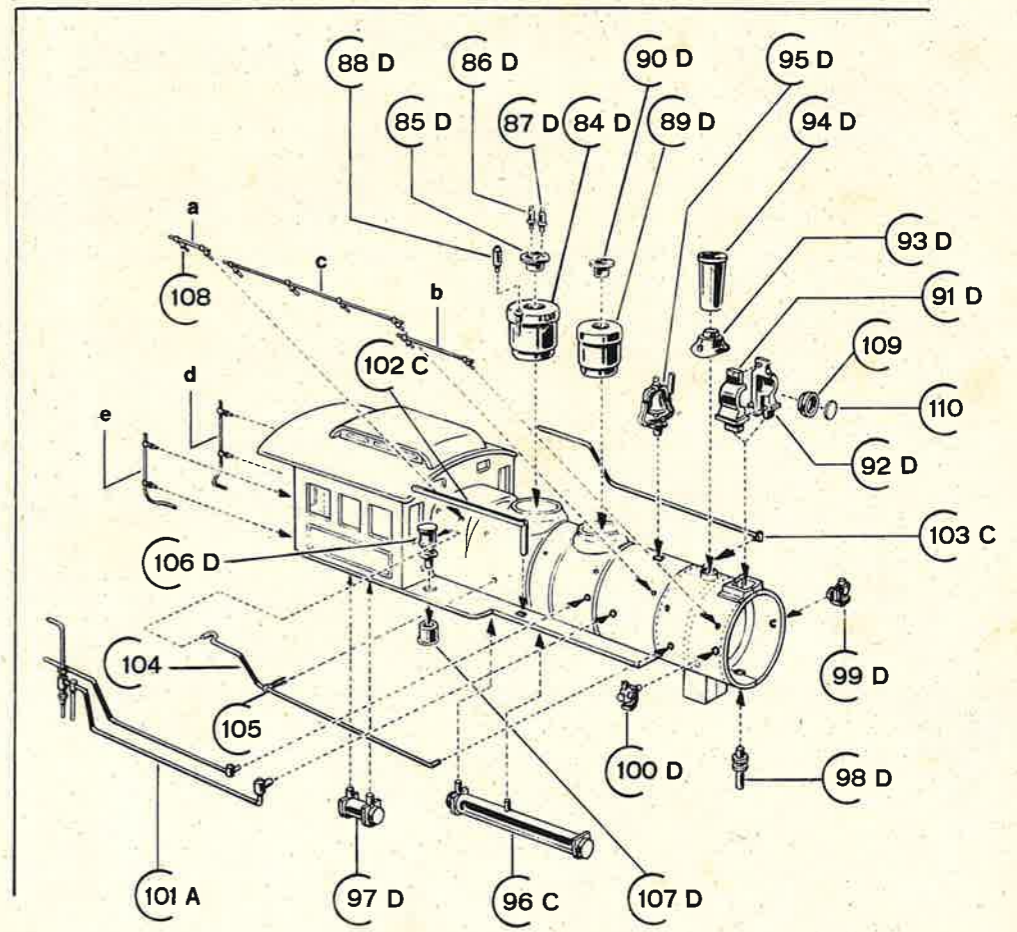

FINAL BOILER ASSEMBLY

Cement in their own housing dome (84D), dome cover (85D). Valves (86D) (87D) and whistle (88D) to be cemented in holes provided in dome cover. Cement sand box (89D) with its cover (90D) on boiler. Cement together head light parts (91D) and (92D) and glue this assembly to boiler. Cement on boiler chimney base (93D) and chimney (94D). Cement also the bell (95D) to boiler. Cement now on footplate: left tank (96C) and the right one (97D). Duct (98D) to be cemented on lower front part of boiler, marker lamps left (99D) and right (100D) on smoke box sides. On right side cement piping (101A) on boiler, inserting ends in holes provided. In same way cement lever (102C). On left side cement pipe (103C) on boiler. Drive small pipe (104) shaped as shown made with wire into split-pin (105). Pipe must be driven in its housing of boiler and of the upper rear part of pump (106D) to be cemented on footplate with underneath part (107D). Split-pin will keep the wire on the boiler (open wide apart the split-pin legs inside the boiler). Now you can spray paint in black this subassembly. Bell (95D) must be painted in gold. Set now handrails (a, b, c) on boiler and (d, e) on cab as follows: shape as shown the handrails in brass wire and drive them into their brackets (108) that have to be forced in holes provided on boiler and cab. Force on head-light, metal ring (109) and glass part (110). (See also figure 8)

9

TENDER ASSEMBLY

AXLES AND WHEELS ASSEMBLY
Drive axles (125) in two hollow axles with wheel (126G) and push them against each other so that axle points equally protrude on each side. If you assemble the motorized version drive axles (125) through hollow axles with wheel (127) following the same praxis.

TRUCK ASSEMBLY - Truck sides and bolster can be spray painted in black before assembling. Fasten screws (50) to truck sides (128F). Assemble truck sides (128F) to front truck bolster (129F) putting in between assembled axles with wheels and tighten self tapping screws (50). Repeat operation for rear truck

